

# PM THENE-TEC

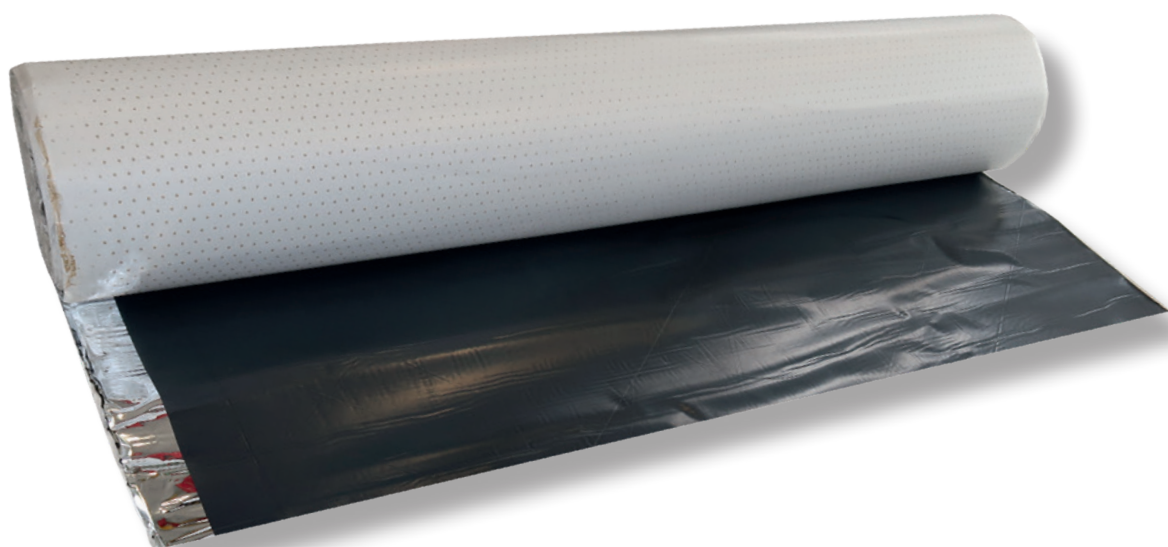

PM THENE-TEC is the combination of a cross-laminated Valeron film and a sealing adhesive layer of special bitumen rubber. This combination creates a tear-resistant, stretchable and thus permanently crack-bridging and high-quality sealing layer. PM THENE-TEC is used for sealing ground-contacting cellar walls and floor slabs against ground moisture and non-accumulating seepage water, but also for sealing retaining walls in gardening and landscaping. It also performs a sealing function against capillary rising damp and as a vapour barrier under screeds. As a cold self-adhesive sealing membrane (KSK), PM THENE-TEC complies with EN 13969, EN 14967 and the new waterproofing standard DIN 18533, thus fulfilling all requirements for standard-compliant waterproofing in accordance with DIN 18533 water exposure class W 1.1-E (soil moisture and non-pressing water) and W 1.2-E (non-pressing water in the case of ground-contacting walls and floor slabs in the case of low-permeable soil with drainage). Before applying thermal insulation to ventilated façades, PM THENE-TEC can also be used as protection against condensation water; it can also be used as corrosion protection for underground pipes. It is also ideal for sealing windows/façades. The Valeron film on the top side of PM THENE-TEC provides immediate protection against precipitation as well as high-performance sealing. Its immediate sealing action against water renders it unnecessary to observe a setting time. Excavation pits can be filled immediately after laying PM THENE-TEC and the associated protection and drainage system. The sealing membrane can be easily cut to size and is "wallpapered" cleanly, quickly and reliably from the roll; this makes PM THENE-TEC easy to process, even in narrow excavation pits. The defined layer thickness of 1.5 mm guarantees a uniform sealing layer. Moreover, PM THENE-TEC makes it easy to realize detailed connections to windows and doors as well as inside and outside corners.

## Technical Data

Material	Bitumen rubber as adhesive and sealing layer with cross-laminated HDPE cover foil
Thickness	approx. 1.5 mm
Total weight	approx. 1.6 kg/m <sup>2</sup>
S <sub>d</sub> -value	≥ 400 m
Temperature resistance	-30 °C to +80 °C
Processing temperature	+5 °C to +30 °C, up to -5 °C with a special primer for low temperatures
Dimensions	1.00 m x 15.00 m
Roll weight	approx. 24 kg
Packaging	1 roll upright in box
Storage	Transport and store upright

# INSTALLATION INSTRUCTIONS

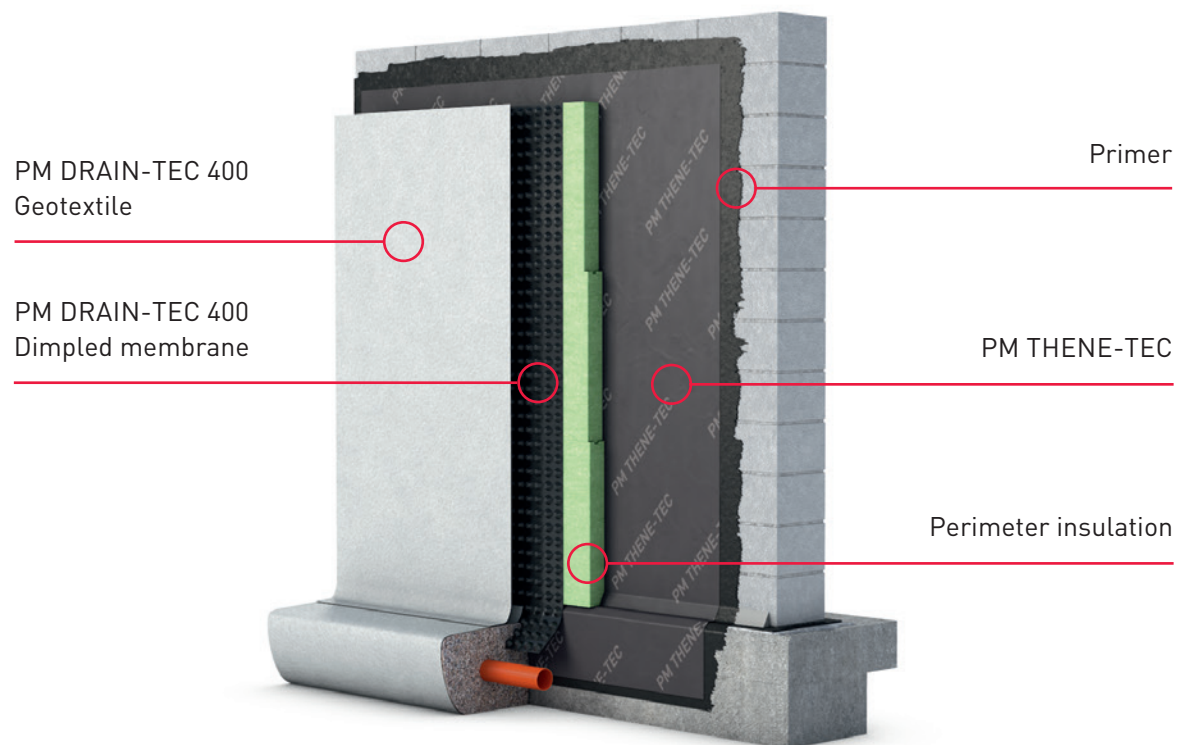

## Finishing

The surface must be smooth, pressure-resistant, clean and stable. Sharp-edged surface irregularities must be removed, and cavities and flaws must be levelled out with a mortar. Proceed as follows:

Prime all mineral surfaces with a bituminous primer. The amount of primer used and how it dries depends on the surface, air humidity and outside temperature. After drying, seal the primed surface on the same day if possible and check its adhesion to the surface. Before laying the product over the surface, glue cuttings or thin reinforcing strips onto details such as inside and outside corners. Before bonding, cut PM THENE-TEC to the appropriate length of the surface to be sealed on a supporting surface and then roll up the cutting again. Peel off the protective paper on the underside at the beginning of the sheet and stick from top to bottom from the centre of the sheet to the edges over the entire

surface and without air pockets. The seam and joint overlap should be approx. 10 cm. Carefully rework all overlaps with a pressure roller. For vertical installation, the upper edge closure must be secured with capping or pressure strips. As the final step, protect the finished sealing by applying PM DRAIN-TEC as a full-surface protection and surface drainage. Now the excavation pit can be filled immediately – with no setting time at all.

## Notes

In very warm weather, it is important to store the sealing membrane in a cool and shady place. At very low temperatures, solar heat can be used to heat the sealing membrane. Always store the rolls upright and only remove the protective carton prior to use.

## Accessories:

PM BUTYL ADHESIVE TAPE | PM POWER FIX cartridge adhesive | PM REPAIR TAPE